

# Laminate Flooring

## INSTALLATION INSTRUCTIONS

### QUICK CHECKLIST

1. Store the unopened packages in room the floor will be installed at least 48 hours prior to installation
2. This floor will be a floating installation, i.e. always keep a distance to all fixed construction parts
3. Check your sub-floor construction it must be clean, dry, and level (measure always!)
4. Choose underlay materials according to your own situation – all floors are unique!
5. Measure the room, decide installation direction
6. Floor heating – see special advices and requirements and follow the instructions from the system supplier
7. Install according to instruction below. Work clean! Please note panel release method.
8. Check your floor continuously during the installation
9. Installed mistakes or defect boards can easily be replaced
10. Always keep room climate at 45-60% RH at 64-75°F (18-24°C)  
Maintain/clean your FLOOR correctly for a lifetime of enjoyment

### TOOLS NEEDED

Spacers, hand-block, fine tooth saw, pencil measuring tape, hammer, glue (chisel and drill)

### PREPARATION

Store your unopened floor packages for 48 hours well spread (not on a pallet) and in the same conditions (45-60% RH at 64-75°F [18-24°C]) as it must have after installation.

Investigate your sub floor: Wall to wall carpets must be eliminated. You can install on all kind of construction floors, if they are dry, flat, fixed and clean, for example on old wood floors, cement/concrete floors, ceramic tiles, PVC etc. DRY: Measure always cement screed / concrete / anhydrite with adequate test instruments. Cement screed / Concrete need much time to dry – in worst cases up to one year after poured. PLEASE note that all types of cement screed / concrete / tiles sub floors require a moisture barrier – an ageing resistant PE – plastic film, min 0.20mm thick overlapping and taped. Flat: Measure always with a vertical positioned floor plank.

Unevenness  $\pm 1/8"$  over 8' must be levelled. Tip: use flooring paper or newspaper to level your sub floor – never use foams or other soft materials. Check always the floor afterwards. Clean: Cross check old wood floors, nail/screw to eliminate squeaking. Sweep or vacuum clean your sub-floor – work clean!

**Underlayment:** It is recommended to always use PE film moisture barrier. Sound insulation material must be installed over the PE-plastic film, if used. Use of sound installation underlay will increase comfort and sound qualities of your floor. Use HD- foams cork sheet, or other approved underlay materials for best results.

**Radiant-Heated Subfloors:** Important issues for installation over sub – floor heating.

Max allowed temperature on top of the laminate floor is 80°F (27°C). Follow the heating regulation recommendations given by the system supplier. Please note that a 0.2mm PE-plastic film always must be placed on top of the construction floor made of cement screed / concrete. Separate floor areas not having sub-floor heating with expansion joint.

**Floating installation:** Your floor is made to be installed floating without being glued or nailed down: Leave an open expansion gap of 1/2" around the whole perimeter and any fixed objects, use spacing wedges. The floor must be able to move freely – do not connect or install tight to any construction part. Expansion joints are required for floor areas more than 900 square feet having dimensions greater 30 feet in either width or length and when installing rooms with off square areas (like L, F, T, or U- shapes). It is always recommended to install expansion spaces at door openings.

**Installation preparations:** Measure the area to be installed and define the installation direction. It is recommended to install the length direction of the planks parallel to the main light direction. The board width of last row shall not be less than 2". If so, adjust the width of the first row to be installed. When measuring take the perimeter expansion requirement of 1/2" into account. In narrow hallways, install the floor parallel to the length way.

# INSTALLATION OF FLOOR PANELS

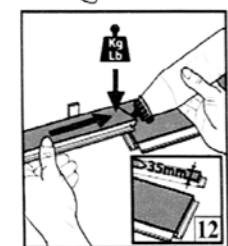
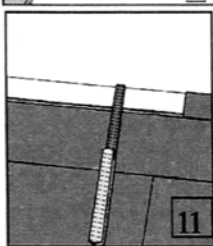
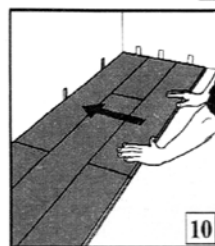
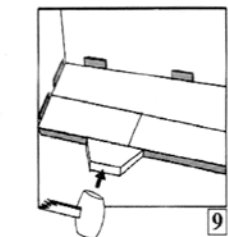
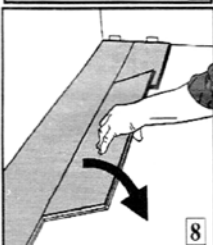
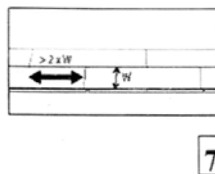
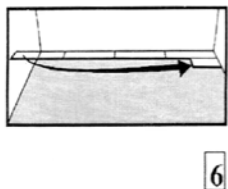
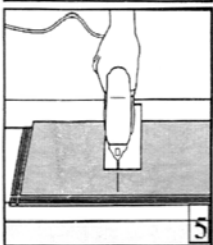
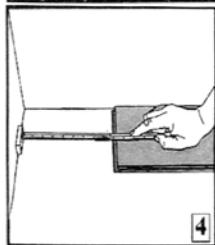
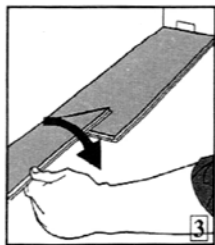
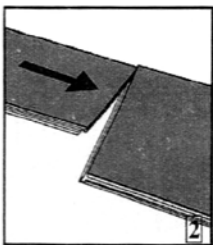
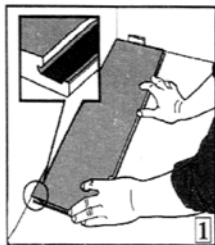

**Fig 1:** First plank, first row: Start in a right-hand corner of the room with locking strip (groove) facing the room. Remember to leave a 1/2" expansion gap between the wall (right) and the board. It is practical to adjust the gap between the long sides and the wall later, when three rows have been installed.

**Fig 2:** Second plank, first row: Place next floorboard tight to the short end of the first one in the corner.

**Fig 3:** Then fold down with a single action movement. Make sure the long sides of the planks make a straight line. Complete the first row in the same way.

**Fig 4:** At the end of first row, put a distance 1/2" expansion spacer to the wall and measure the length of the last plank to fit.

**Fig 5:** Cut with a saw – The teeth of the saw should cut into the panel surface to minimize chipping.

**Fig 6:** Second row: First plank min length: half of full length panel. Do not forget expansion gap against the wall

**Fig 7:** General: Minimum distance between short ends of planks in parallel rows shall not be less than 2 times the width(W) of the panel.

**Fig 8:** Second plank 2nd row: Place the floorboard tight to the short end of the previous panel and fold down in a single action movement

**Fig 9:** General: Use a tapping block and hammer (if needed) to ensure joints are connected ease installation of tight seams. "Tap" GENTLY to avoid damage to your panels.

**Fig 10:** After 2-3 rows: Adjust the distance to the front wall by placing 1/2" expansion space.

**Fig 11:** Last row (and perhaps also first row): Minimum floorboard width = 2". Remember expansion distance Tip! Include expansion distance when measuring and cut the panels lengthwise. Glue the short end joints.

**Fig 12:** First /last rows: Joining length cut panels, use white PVA carpenters wood glue on any planks less than 12" long or 2" wide or on any planks where the lip of the groove has been shaved off.

**Special installations:** Horizontal installation : Cut off the locking element with a chisel, put white glue (PVAc) on the adjusted strip and push the planks horizontally together. If necessary place some spacers between last board and the wall during the hardening time of the glue.

### After the installation

Remove all spacers Skirtings and / or quarter round must be fixed to the walls (never to the floor) You can use the floor immediately after installation.

Your floor can be very easy disassembled (angle up at short ends opposite the installation way, as shown in fig8) which enables simple replacement during installation and also during use.

Room climate – If the climate is not kept correct or floor not installed with expansion, by natural properties the floor can show fine gaps, at dry climate also concave (cupping boards) or at high RH%: convex boards.

### Cleaning and maintenance

The floor should be cleaned by using a vacuum-cleaner or broom. If required, wipe with a damp-dry (well squeezed) cloth. Avoid using large amounts of water. Use an approved laminate floor cleaner or similar when desired and according to directions.

Spillage must be dried immediately: Rugs at entrance areas will help protect against sand and dirt

Felt pads should be attached to furniture legs to avoid marking.