

## Installation Instructions

3L TripleLock & Click4U

Using your hands



INNOVATIONS  
4 FLOORING

1

### PREPARE FLOOR

Underlay on dry and leveled underfloor

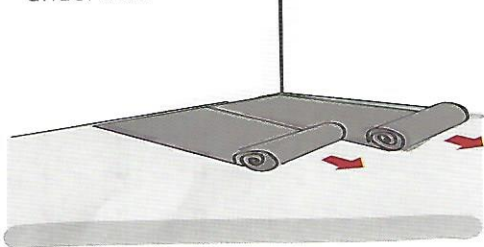

2

### SET SPACERS

Place spacers equaling the thickness for required expansion gap between plank and wall on short and long ends of plank.

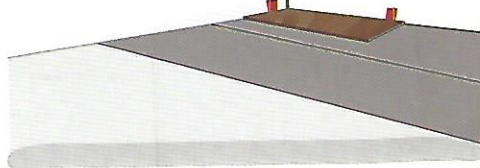

3a

### SHORT SIDE

3L TripleLock - One piece drop-lock system

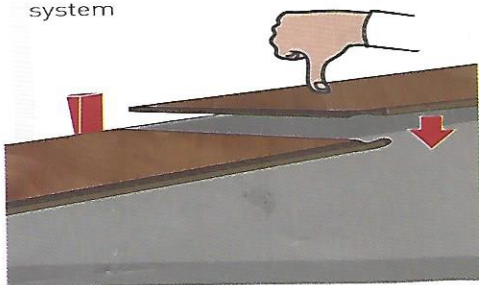

3b

### Secure 3x locking

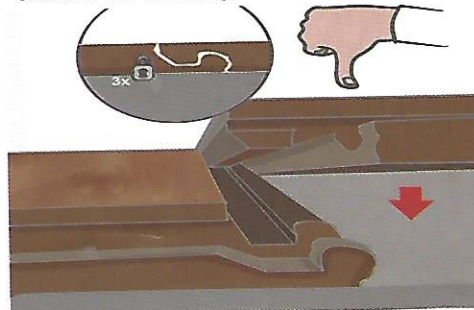

4

### LONG SIDE

Click4U - Angle-system

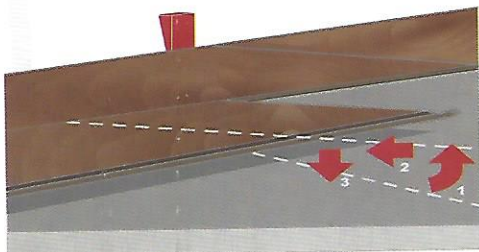

5

### Easy angle/drop-lock installation

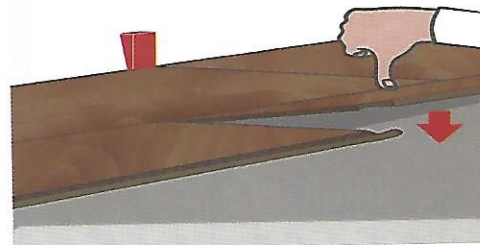

[www.innovations4flooring.com](http://www.innovations4flooring.com)

## Installation Instructions

3L TripleLock & Click4U

Using a rubber hammer



INNOVATIONS  
4 FLOORING

1

### PREPARE FLOOR

Underlay on dry and leveled underfloor

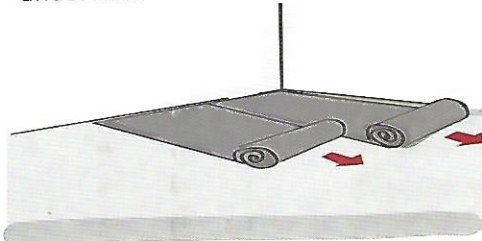

2

### SET SPACERS

Place spacers equaling the thickness for required expansion gap between plank and wall on short and long ends of plank.

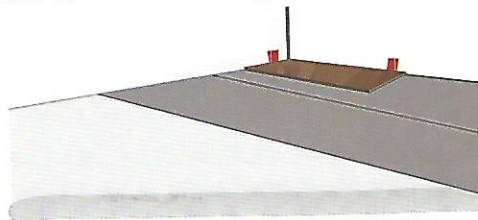

3a

### SHORT SIDE

3L TripleLock - One piece drop-lock system



3b

### Secure 3x locking

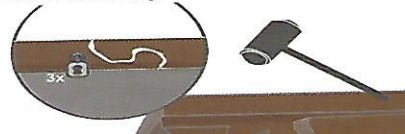



**4** LONG SIDE  
Click4U - Angle-system

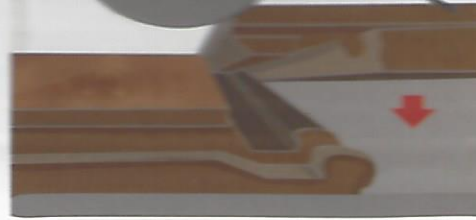
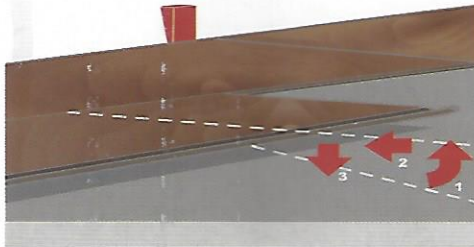

**5** Easy angle/drop-lock installation

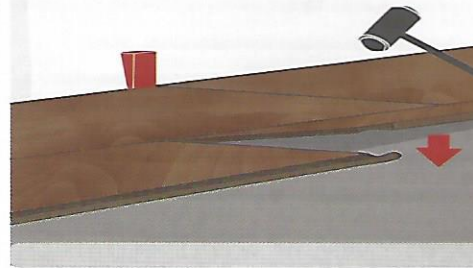

[www.innovations4flooring.com](http://www.innovations4flooring.com)

**Step by Step instructions**  
3L TripleLock & Click4U  
One piece drop-lock system

INNOVATIONS  
4 FLOORING

**The easiest and fastest one piece drop-lock system** for the short side on the market!

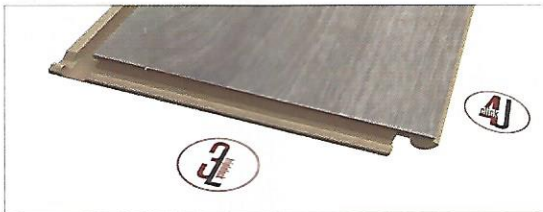

**1** LONG SIDE  
Start by engaging the plank on the long side (angle-system)

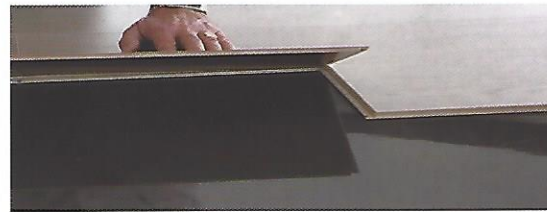

**2** SHORT SIDE  
To engage on the short side, let the plank drop easily.

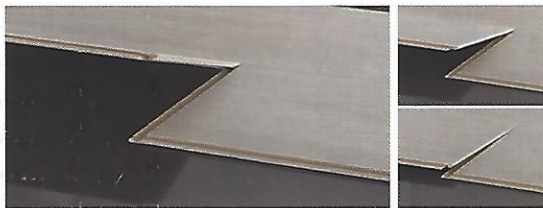

**3** LOCKING SYSTEM - 3L TripleLock  
Push with your thumb on both ends of the short side until you hear the "Click" sound of the one piece drop-lock system.



**4** DISENGAGE - long side  
Start disengaging on the long side by lifting the plank in angle position.



**5** DISENGAGE - short side  
To disengage on the short side, softly slide the planks in opposite directions.

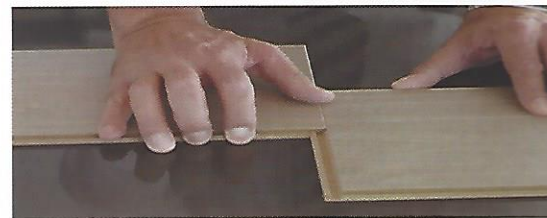

[www.innovations4flooring.com](http://www.innovations4flooring.com)